

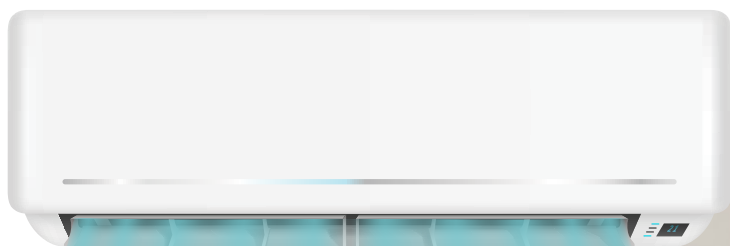

GREENBREEZE



EUROPE



FRESH AIR

FRESH LIFE!



[www.green-breeze.eu](http://www.green-breeze.eu)





# CAPACITOR

## Overview:

This capacitor takes heavy-edge metalized AL/ZN PP film as dielectric, coiled by high speed winding machine, liquid filled aluminum case and protective device structure with.. It is treated by using refined castor oil or wax as an impregnant in the high temperature and vacuum environment to make the capacitor more stable with long working life. Meanwhile based on the principle of safety and proof-explosion, this kind of capacitors has been used the second age mechanical explosion design to strengthen the reliability. The product adopts single and combined structures.

## Usages:

The products is suitable for home appliances like air- conditioners, air coolers, freezers and machine. etc

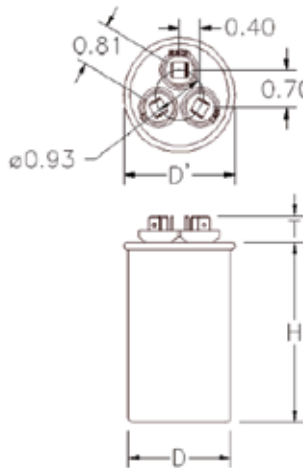

Capacitance (uF)	Voltage	Frequency	Temp Range
5 uF	450V	50/60Hz	-400C-850C
10 uF	450V	50/60Hz	-400C-850C
15 uF	450V	50/60Hz	-400C-850C
20 uF	450V	50/60Hz	-400C-850C
25 uF	450V	50/60Hz	-400C-850C
30 uF	450V	50/60Hz	-400C-850C
35 uF	450V	50/60Hz	-400C-850C
40 uF	450V	50/60Hz	-400C-850C
45 uF	450V	50/60Hz	-400C-850C
50 uF	450V	50/60Hz	-400C-850C
55 uF	450V	50/60Hz	-400C-850C
60 uF	450V	50/60Hz	-400C-850C
65 uF	450V	50/60Hz	-400C-850C
20 + 5 uF	450V	50/60Hz	-400C-850C
30 + 5 uF	450V	50/60Hz	-400C-850C
35 + 5 uF	450V	50/60Hz	-400C-850C
40 + 5 uF	450V	50/60Hz	-400C-850C
45 + 5 uF	450V	50/60Hz	-400C-850C
50 + 5 uF	450V	50/60Hz	-400C-850C
55 + 5 uF	450V	50/60Hz	-400C-850C
60 + 5 uF	450V	50/60Hz	-400C-850C
65 + 5 uF	450V	50/60Hz	-400C-850C



# CONTACTOR

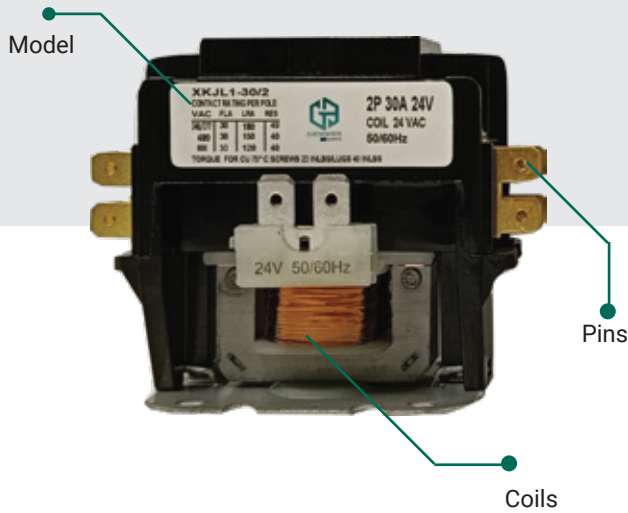

## Overview:

Our extensive product lineup includes a wide selection of contactors, ranging from 2-pole to 3-pole configurations, with various current and voltage ratings to suit diverse requirements. Whether you need a compact and efficient solution for residential applications or a rugged and robust contactor for industrial environments, we have you covered.

## Features

- Low VA coil for cooler operation and increased life
- Quiet operation
- Universal style mounting bracket fits existing mounting holes
- Double break contacts ensure positive make and break
- Screw terminals or lugs and quad 1/4" quick connects provided on all models for easy installation
- Long electrical life; tested to 250,000 cycles
- Superior copper coil
- Performance unaffected by mounting position

Model			Locked Rotor Amps	Resistive Amps
Poles	F/L Inductive Amps	Coil Voltage		
2 Pole	30 AMP	24V	180/150/120	40
2 Pole	30 AMP	240V	180/150/120	40
2 Pole	40 AMP	24V	240/200/160	50
2 Pole	40 AMP	240V	240/200/160	50
3 Pole	40 AMP	24V	240/200/160	50
3 Pole	40 AMP	240V	240/200/160	50

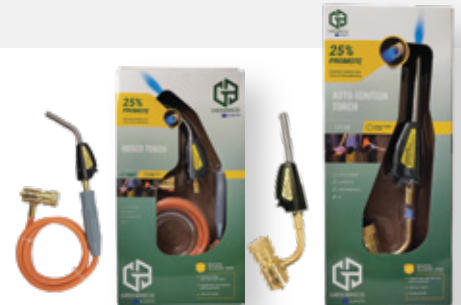

## GAS TORCH

Tip diameter:  
11.50mm

Secondary  
burner tube valve

Trigger-start  
igniter

### WT-8

#### DOUBLE TORCH FOR BIG OBJECT HEAT-TREATING

A 360° vertical swivel double-barrels torch and trigger-start ignition provide easy, one-hand accessibility to soldering & brazing & heating the bigger object jobs.

- The torch can be adjusted into one or two flames for the flexible applications
- Double flames can provide more heat distribution for soldering, brazing, heat-treating and automotive repair.
- For best performance, use with 400g PRO GAS, but Propane is also suitable with lower heat
- 100% rugged brass inter-structure to avoid the gas-leakage, 100% fire tested
- Advanced gas control system to easily adjust the size flame for different applications
- Flame stable for consistent performance when tilted or momentarily inverted

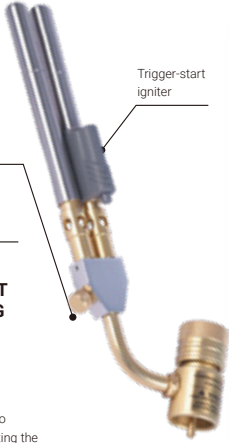

Tip diameter: 11.50mm

Trigger-start igniter

Secondary burner  
tube valve

Flame adjustable  
valve on handle

### WT-10

#### DOUBLE HOSE TORCH FOR ACCESSIBILITY AND BIG OBJECT

Easily access hard-to-reach soldering & brazing and heat-treating jobs with the WT-10 Hose Torch. Features a hose and double flames for maximum accessibility and applications.

- The torch can be adjusted into one or two flames for the flexible applications
- Gas control valve on handle makes it easy to precision flame/ignite/extinguish the flame.
- 1.5M hose plus the belt hook for maximum accessibility and mobility.
- Double Turbo&swirl flame provide more heat distribution for soldering, brazing, heat treating and light welding
- For best performance, use with 400g PRO GAS, but Propane is also suitable with lower heat
- Brass tip and 100% rugged brass inter-structure to avoid the gas-leakage, 100% fire tested

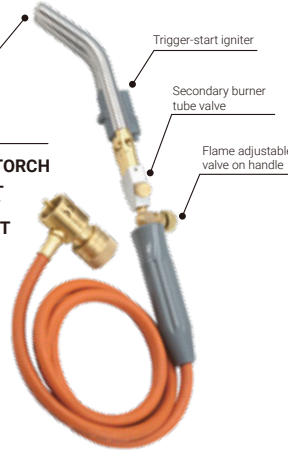

### HT-1S660

#### HOSE TORCH FOR ACCESSIBILITY AND MOBILITY

Easily access hard-to-reach soldering & brazing and heat-treating jobs with the HT-1S660 Hose Torch. Features a hose for maximum accessibility.

- 1.5M hose plus the belt hook for maximum accessibility and mobility.
- Turbo&swirl flame provide more heat distribution for soldering, brazing, heat treating and light welding
- For best performance, use with 400g PRO GAS, but Propane is also suitable with lower heat
- 100% rugged brass inter-structure to avoid the gas-leakage, 100% fire tested



### HT-1S

#### 360° SWIVEL TORCH TO ACCESS TIGHT SPOTS

A 360° vertical swivel torch head and trigger-start igniter provide easy, one-hand accessibility to soldering & brazing & heating jobs in tight spaces.

- Turbo&swirl flame provide more heat distribution for soldering, brazing, heat-treating and automotive repair.
- For best performance, use with 400g PRO GAS, but Propane is also suitable with lower heat
- 100% rugged brass inter-structure to avoid the gas-leakage, 100% fire tested
- Advanced gas control system to easily adjust the size flame for different applications
- Flame stable for consistent performance when tilted or momentarily inverted

3 Years Warranty

#### AVAILABLE KITS

HT-1STK  
HT-1S Torch Plus 1pc 400g PRO GAS Cylinder



## GREENBREEZE Mapp Gas Torch

GREENBREEZE extensive line of the Mapp gas torches and burners are ideal for brazing & soldering & heating applications on the Plumbing, HVAC, automotive repair, hardware and DIY jobs. It is famous for extremely turbo flame design of the maximum heating. These include heavy brass inter-structure and anti-flashback design that make the torch to be outstanding and safe to use.



## AIR CONDITIONING BRACKET

### Overview:

Air conditioning brackets are often made of heavy-duty steel or other durable materials to support the weight of the air conditioner reliably. The material should be corrosion-resistant to withstand outdoor conditions.

### Features

- **Material:** AC brackets are typically made of durable materials such as steel, aluminum, or heavy-duty plastic to provide sturdy support for the air conditioning unit.
- **Adjustability:** Many brackets offer adjustable features to accommodate different sizes and weights of air conditioning units. This adjustability ensures a secure fit and proper support.
- **Capacity:** Brackets come with weight capacity ratings to ensure they can safely support the specific air conditioning unit. Capacity may vary depending on the size and design of the bracket.
- **Weather Resistance:** Outdoor AC brackets are often designed to withstand various weather conditions, including rain, snow, and UV exposure, to ensure long-lasting durability.

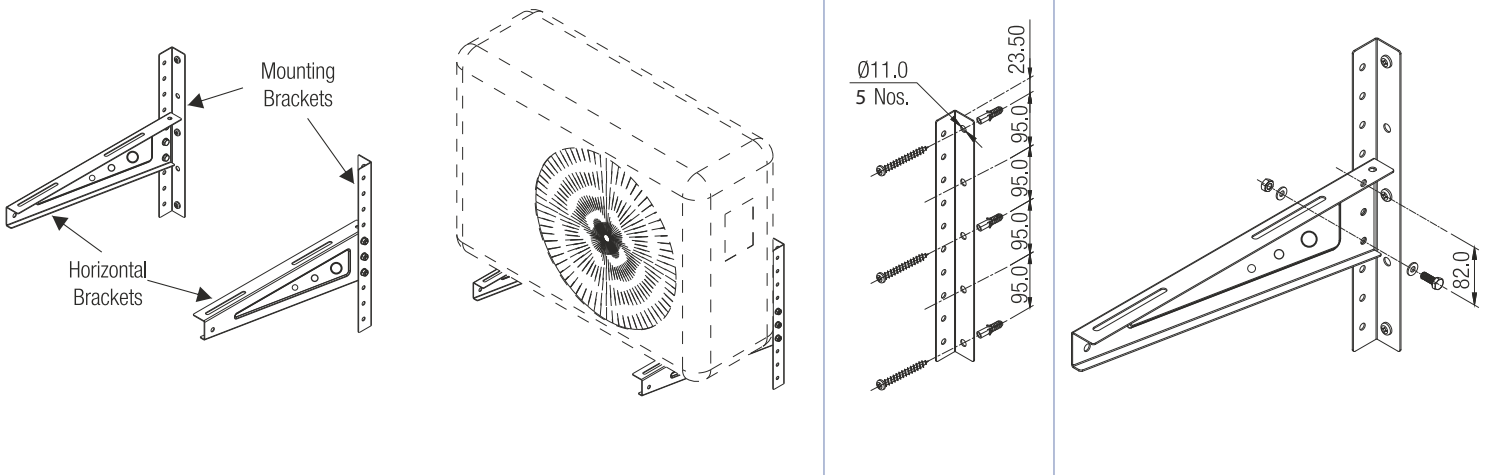

Model	Products Size	Max load weight	Color
AC DO 01	500 x 500 x 2.0 mm	150 KGS ( 400 LBS )	White
AC DO 02	550 x 550 x 2.0 mm	200 KGS ( 440 LBS )	White
AC DO 03	600 x 600 x 2.0 mm	250 KGS ( 550 LBS )	White



# LIQUID LINE FILTER DRIER

## PRODUCT FEATURE

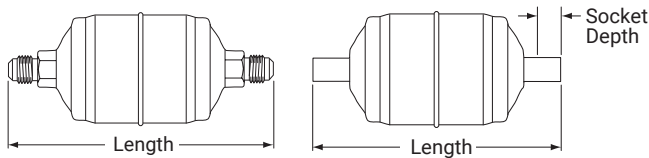

## Overview:

Liquid line filter driers are essential components in air conditioning and refrigeration systems, tasked with removing moisture, contaminants, and debris from the refrigerant. Here are some typical features you might find in these products:

## Features

- **Filtration Capacity:** Liquid line filter driers are designed to trap contaminants and debris present in the refrigerant, preventing them from circulating through the system and causing damage to components such as compressors and expansion valves.
- **Moisture Removal:** One of the primary functions of filter driers is to absorb moisture from the refrigerant, preventing it from causing corrosion or icing within the system. The moisture removal capacity varies depending on the type and size of the filter drier.
- **Contaminant Removal:** Filter driers capture various contaminants, including dirt, acids, and solid particles, to maintain the cleanliness and efficiency of the air conditioning or refrigeration system.
- **Desiccant Material:** Filter driers contain desiccant materials such as molecular sieves or activated alumina, which have high adsorption capacity for moisture and contaminants.

Model	Size	Usage	Max. Working Pressure	Temp. Range
EK-162	1/4" SAE	HFC / HCFC / CFC	4.7 Mpa / 680 / PSIG	-40 to +70°C
EK-162S	1/4"ODF	HFC / HCFC / CFC	4.7 Mpa / 680 / PSIG	-40 to +70°C
EK-162S	3/8" SAE	HFC / HCFC / CFC	4.7 Mpa / 680 / PSIG	-40 to +70°C
EK-162S	3/8" ODF	HFC / HCFC / CFC	4.7 Mpa / 680 / PSIG	-40 to +70°C
EK-162S	1/2" SAE	HFC / HCFC / CFC	4.7 Mpa / 680 / PSIG	-40 to +70°C
EK-162S	1/4" ODF	HFC / HCFC / CFC	4.7 Mpa / 680 / PSIG	-40 to +70°C
EK-162S	5/8" SAE	HFC / HCFC / CFC	4.7 Mpa / 680 / PSIG	-40 to +70°C
EK-162S	1/4"ODF	HFC / HCFC / CFC	4.7 Mpa / 680 / PSIG	-40 to +70°C
EK-162S	3/4"SAE	HFC / HCFC / CFC	4.7 Mpa / 680 / PSIG	-40 to +70°C
EK-162S	7/8"SAE	HFC / HCFC / CFC	4.7 Mpa / 680 / PSIG	-40 to +70°C



## D-48 STANDARD CAPACITY



### PRODUCT FEATURE



### Overview:

Our D-48 series is designed to offer reliable and efficient solutions for your cooling and refrigeration needs. Explore our catalogue to discover the features, specifications, and benefits of our D-48 standard capacity products.

- **High Performance:** The D-48 series is engineered for optimal cooling and refrigeration performance, ensuring efficiency and reliability.
- **Durability:** Built with high-quality materials and advanced technology, D-48 products are designed for long-lasting durability and minimal maintenance.
- **Versatility:** Suitable for a variety of applications, including commercial refrigeration, air conditioning systems, and industrial cooling processes.

Block	R-22	R-134a	R-404A	Recommended Use
D-48	445	515	557	CFC's/Mineral Oil
H-48	697	756	771	High Moisture
W-48	435	476	490	High Acid/Burnout
UK-48	1331	1344	1274	POE Lubricants/ all refrigerants
RH-48	1037	1096	1090	Refrigerant Reclaim Max. Moisture
RW-48	532	583	600	Refrigerant Reclaim Max. Acid
RD-48	512	592	640	Refrigerant Reclaim Std. Capacity



1/8" - 1 1/8"  
TUBE CUTTER



1/8" - 7/8"  
TUBE CUTTER



FLARING TOOLS



PVC TAPE



## REFRIGERANT GAS



### 410a Refrigerant

- **Environmentally Friendly:** GREENBREEZE 410a is chlorine-free and does not contribute to ozone depletion, making it a sustainable choice for cooling applications.
- **High Energy Efficiency:** Engineered for optimal energy efficiency, GREENBREEZE 410a helps reduce electricity consumption and operating costs.
- **Wide Compatibility:** Compatible with most existing R-22 systems, GREENBREEZE 410a offers a seamless transition for retrofitting or new installations.
- **Reliable Performance:** With proven stability and reliability, GREENBREEZE 410a ensures consistent cooling performance in diverse conditions.



### 134a Refrigerant

- **Environmentally Friendly:** GREENBREEZE 134a is chlorine-free and has a low global warming potential (GWP), making it a sustainable choice for cooling applications.
- **High Efficiency:** Engineered for optimal cooling performance, GREENBREEZE 134a helps improve energy efficiency and reduce operating costs.
- **Versatile Application:** Suitable for a wide range of refrigeration and air conditioning systems, GREENBREEZE 134a offers versatility and reliability in various environments.
- **Safety Assurance:** GREENBREEZE 134a undergoes rigorous testing to ensure compliance with industry safety standards, providing peace of mind for users.



### 404a Refrigerant

- **Environmentally Friendly:** GREENBREEZE 404a has zero ozone depletion potential (ODP), making it a sustainable choice for commercial refrigeration applications.
- **High Efficiency:** Engineered for optimal performance in medium and low-temperature refrigeration systems, GREENBREEZE 404a helps improve energy efficiency and reduce operating costs.
- **Versatility:** Suitable for a wide range of commercial refrigeration applications, including supermarkets, cold storage, and food processing, GREENBREEZE 404a offers versatility and reliability.
- **Safety:** GREENBREEZE 404a undergoes rigorous testing to ensure compliance with industry safety standards, providing peace of mind for users.



### 407c Refrigerant

- **Environmentally Friendly:** GREENBREEZE 407c is a chlorine-free refrigerant with zero ozone depletion potential (ODP), making it a sustainable choice for cooling applications.
- **Energy Savings:** Enjoy reduced energy consumption and lower operating costs with GREENBREEZE 407c's high-efficiency cooling capabilities.
- **Reliability:** Count on GREENBREEZE 407c for consistent and dependable cooling performance, ensuring comfort and productivity.
- **Regulatory Compliance:** GREENBREEZE 407c complies with international environmental regulations, ensuring regulatory compliance and peace of mind.



GREENBREEZE UNIPessoal LDA  
Rua Da Praia Azul, Silveira  
Lisbon, Portugal  
[www.green-breeze.eu](http://www.green-breeze.eu)

## Marketed By:

---

Cannelle Holdings FZE  
P O Box 261660, Jebel Ali Free Zone  
Dubai, United Arab Emirates  
Tel: +971 4 8861858  
[www.cannelleholdings.com](http://www.cannelleholdings.com)